

Multifunctional Pneumatic Actuators

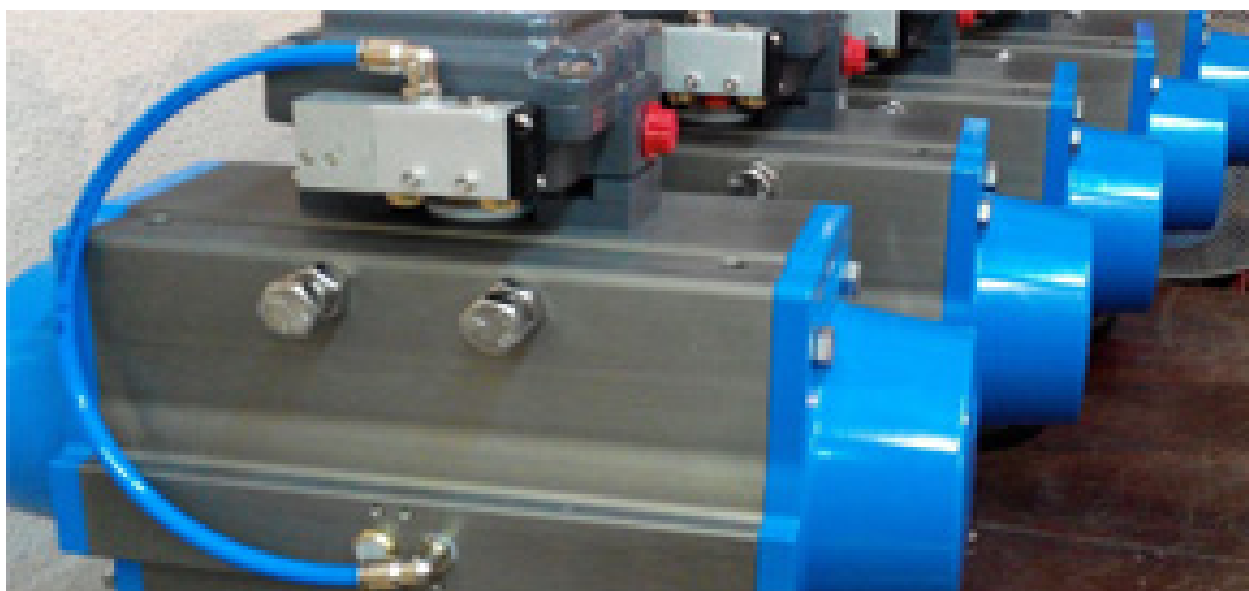

Архангельск (8182)63-90-72
Астана (7172)727-132
Астрахань (8512)99-46-04
Барнаул (3852)73-04-60
Белгород (4722)40-23-64
Брянск (4832)59-03-52
Владивосток (423)249-28-31
Волгоград (844)278-03-48
Вологда (8172)26-41-59
Воронеж (473)204-51-73
Екатеринбург (343)384-55-89

Иваново (4932)77-34-06
Ижевск (3412)26-03-58
Иркутск (395)279-98-46
Казань (843)206-01-48
Калининград (4012)72-03-81
Калуга (4842)92-23-67
Кемерово (3842)65-04-62
Киров (8332)68-02-04
Краснодар (861)203-40-90
Красноярск (391)204-63-61
Курск (4712)77-13-04
Липецк (4742)52-20-81

Магнитогорск (3519)55-03-13
Москва (495)268-04-70
Мурманск (8152)59-64-93
Набережные Челны (8552)20-53-41
Нижний Новгород (831)429-08-12
Новокузнецк (3843)20-46-81
Новосибирск (383)227-86-73
Омск (3812)21-46-40
Орел (4862)44-53-42
Оренбург (3532)37-68-04
Пенза (8412)22-31-16

Пермь (342)205-81-47
Ростов-на-Дону (863)308-18-15
Рязань (4912)46-61-64
Самара (846)206-03-16
Санкт-Петербург (812)309-46-40
Саратов (845)249-38-78
Севастополь (8692)22-31-93
Симферополь (3652)67-13-56
Смоленск (4812)29-41-54
Сочи (862)225-72-31
Ставрополь (8652)20-65-13

Сургут (3462)77-98-35
Тверь (4822)63-31-35
Томск (3822)98-41-53
Тула (4872)74-02-29
Тюмень (3452)66-21-18
Ульяновск (8422)24-23-59
Уфа (347)229-48-12
Хабаровск (4212)92-98-04
Челябинск (351)202-03-61
Череповец (8202)49-02-64
Ярославль (4852)69-52-93

Киргизия (996)312-96-26-47 Казахстан (772)734-952-31 Таджикистан (992)427-82-92-69

www.achem.nt-rt.ru || afc@nt-rt.ru



C 系列气动执行器

C Series Pneumatic Actuators

7. Large stroke actuator / 大行程气动执行器

7.1 An actuator with a rotation stroke of more than 120° is called a large stroke actuator. Based on our standard stroke (90°) actuator, as long as we are equipped with large stroke pistons and body and specially designed cam, the actuator will be able to perform the work of a large stroke. This stroke can be determined according to the needs of the customer, such as 120°, 130°, 180°, and so on.

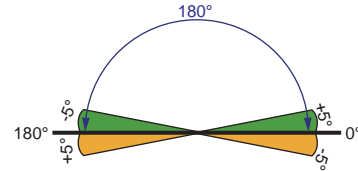
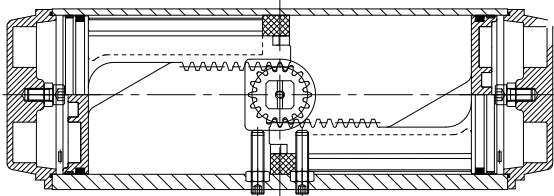

7.2 The size of the large stroke actuator is the same as that of the standard actuator, except for the length which are shown in tabel below.

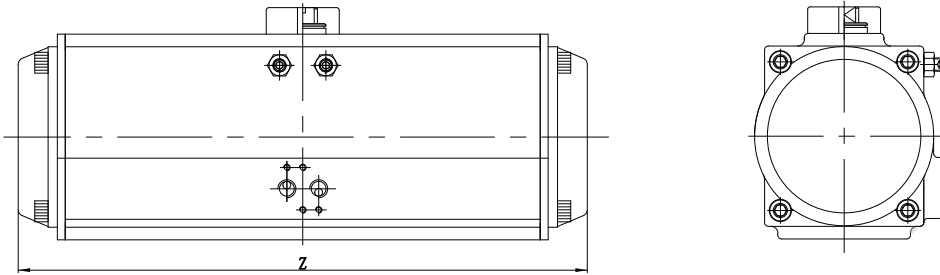

Unit:mm

Model	C52-180DA	C63-180DA	C75-180DA	C83-180DA	C92-180DA	C105-180DA	C125-180DA	C140-180DA	C160-180DA	C190-180DA	C210-180DA
Z	211	243	258	298	362	394	429	583	666	764	768

Note that the top of the large stroke actuator at C125 and above size is equipped with two mounting rings.

7.3 The output torque is the same as that of the standard actuator of 90°. Note that our C series large stroke actuator is only available for double acting now.



8. Three-position pneumatic actuator / 三位式气动执行器

8.1 The three-position actuator is mainly used for the process control of three-way or four way valve or other three-position rotating device. We can provide two types of three-position pneumatic actuators. one is 90° three-position actuator which can perform stroke operation in three positions within the range of 90°, such as 0°, midway and 90°, MD = (20°, 80°), and the other one is 180° three-position actuator which can perform stroke operation in three positions within the range of 180°, such as 0°, midway and 180°, MD = (90°, 170°).

C 系列气动执行器

C Series Pneumatic Actuators

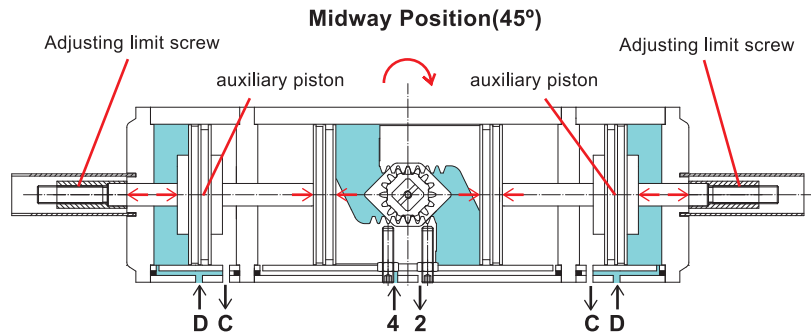

The midway position is achieved by a mechanical stops from 2 auxiliary pistons and adjusting limit screws. The figure above can be seen. Firstly, air to port D forces the auxiliary pistons inwards and then stop in the midway under the restriction of the adjusting limit screw. The screw is external and adjustable. Second, air to port 4 forces the main pistons outwards, causing the pinion to turn clockwise which will be stopped under the restriction of the auxiliary piston bar in midway.

8.2 Most of the dimensions of the three position actuator is the same as that of the standard actuator, except for the length which are shown in table below.

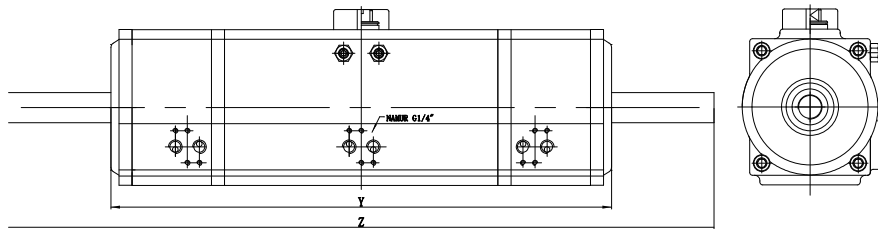

90° three-position actuator with double acting

Unit:mm

Model	C52T90DA	C63T90DA	C75T90DA	C83T90DA	C92T90DA	C105T90DA	C125T90DA	C140T90DA	C160T90DA	C190T90DA	C210T90DA
Y	261	303	306	336	394	409	456	550	648	788	788
Z	369	431	434	500	579	603	660	784	912	1102	1112

90° three-position actuator with spring return

Unit:mm

Model	C52T90SR	C63T90SR	C75T90SR	C83T90SR	C92T90SR	C105T90SR	C125T90SR	C140T90SR	C160T90SR	C190T90SR	C210T90SR
Y	261	313	330	361	432	455	498	630	728	878	879
Z	369	441	454	525	617	649	702	864	992	1202	1203

180° three-position actuator with double acting

Unit:mm

Model	C52T180DA	C63T180DA	C75T180DA	C83T180DA	C92T180DA	C105T180DA	C125T180DA	C140T180DA	C160T180DA	C190T180DA	C210T180DA
Y	333	387	389	441	506	541	599	747	866	1044	1044
Z	431	515	517	596	671	715	773	951	1100	1328	1328

8.3 The output torque is same as that of the standard actuator of 90°. Note that our C series 90° three-position actuator is available for double acting and spring return, but 180° three-position actuator only available for double acting.



ACHEM Mini Pneumatic Actuator

With the air connection interface optimizing design of Wilson, now we have successfully realized the solution to install ACHEM Mini pneumatic actuator (D-32DA) with two -position five-way (5/2) spool valve together which is more direct and compact. The output torque of the small pneumatic actuator can reach 8 Nm at 5 Bar, which is especially suitable for compact installation of DN8 (1/4"), DN10 (3/8") and DN15 (1/2") ball valves with pneumatic actuators. It is widely used in some light industrial machinery with limited space.

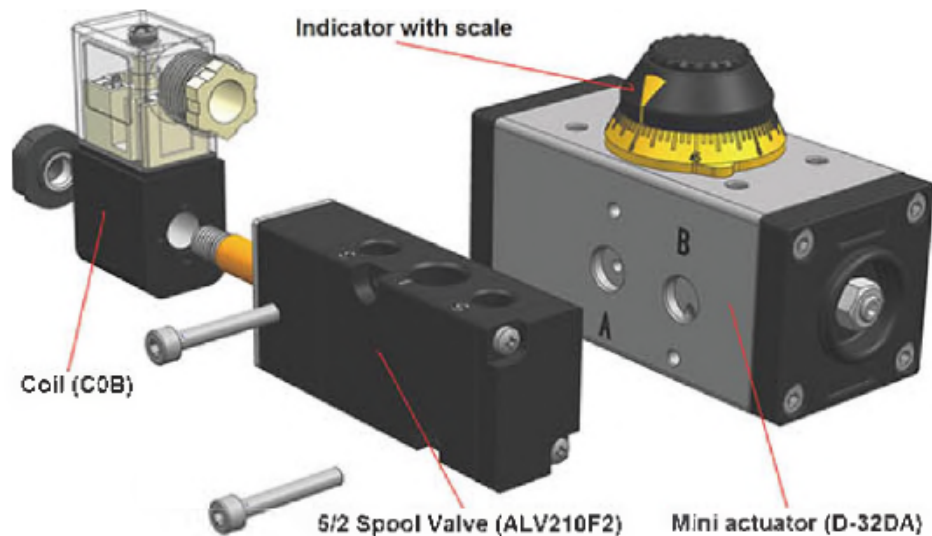

Архангельск (8182)63-90-72
Астана (7172)727-132
Астрахань (8512)99-46-04
Барнаул (3852)73-04-60
Белгород (4722)40-23-64
Брянск (4832)59-03-52
Владивосток (423)249-28-31
Волгоград (844)278-03-48
Вологда (8172)26-41-59
Воронеж (473)204-51-73
Екатеринбург (343)384-55-89

Иваново (4932)77-34-06
Ижевск (3412)26-03-58
Иркутск (395)279-98-46
Казань (843)206-01-48
Калининград (4012)72-03-81
Калуга (4842)92-23-67
Кемерово (3842)65-04-62
Киров (8332)68-02-04
Краснодар (861)203-40-90
Красноярск (391)204-63-61
Курск (4712)77-13-04
Липецк (4742)52-20-81

Магнитогорск (3519)55-03-13
Москва (495)268-04-70
Мурманск (8152)59-64-93
Набережные Челны (8552)20-53-41
Нижний Новгород (831)429-08-12
Новокузнецк (3843)20-46-81
Новосибирск (383)227-86-73
Омск (3812)21-46-40
Орел (4862)44-53-42
Оренбург (3532)37-68-04
Пенза (8412)22-31-16

Пермь (342)205-81-47
Ростов-на-Дону (863)308-18-15
Рязань (4912)46-61-64
Самара (846)206-03-16
Санкт-Петербург (812)309-46-40
Саратов (845)249-38-78
Севастополь (8692)22-31-93
Симферополь (3652)67-13-56
Смоленск (4812)29-41-54
Сочи (862)225-72-31
Ставрополь (8652)20-65-13

Сургут (3462)77-98-35
Тверь (4822)63-31-35
Томск (3822)98-41-53
Тула (4872)74-02-29
Тюмень (3452)66-21-18
Ульяновск (8422)24-23-59
Уфа (347)229-48-12
Хабаровск (4212)92-98-04
Челябинск (351)202-03-61
Череповец (8202)49-02-64
Ярославль (4852)69-52-93

Киргизия (996)312-96-26-47 Казахстан (772)734-952-31 Таджикистан (992)427-82-92-69

www.achem.nt-rt.ru || afc@nt-rt.ru